

RYCO FILTERS



FITTING INSTRUCTIONS FOR RYCO CABIN FILTER RCA144P.

RENAULT CLIO

Filter located in engine compartment

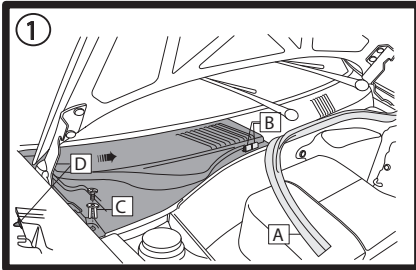

1 Remove the rubber seal (A), pull out the split pin (C), push spring locks (B) towards windscreen, lift the cover to clear spring locks and slide the plug (D) and cover out to remove.

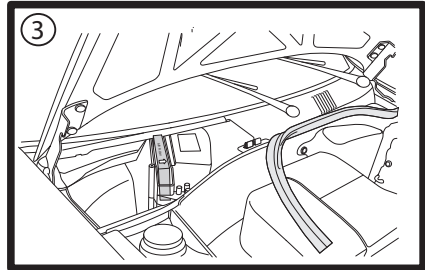

3 Remove used filter & replace with new Ryco RCA144P. Squash element as shown in 4 to remove & fit into housing.

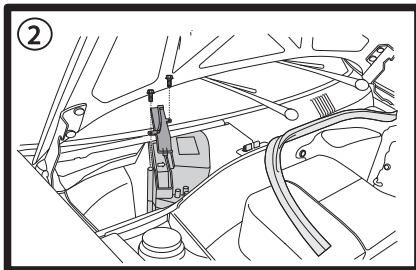

2 Remove the two hex headed screws and remove the filter housing lid.

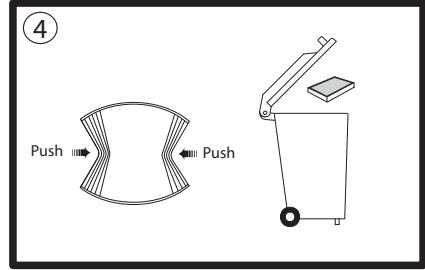

4 Refit all previously removed components in reverse sequence.
Dispose of used filter correctly.

Ryco Group Pty Ltd
29 Taras Ave, Altona North
Victoria 3025 Australia.
www.rycofilters.com.au

Ryco Group
A Division of GUD NZ Holdings Ltd
626A Rosebank Road, Avondale
Auckland New Zealand
www.ryco.co.nz

RYCO FILTERS



FITTING INSTRUCTIONS FOR RYCO CABIN FILTER RCA144P.

RENAULT MEGANE (Filter located in engine compartment)

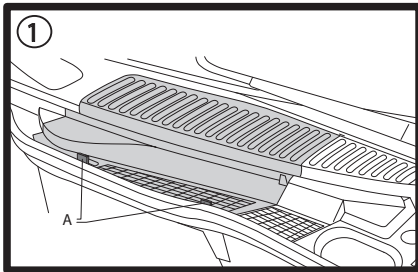

Release clips (A) by pulling towards front of vehicle, raise the cover and lift it out.

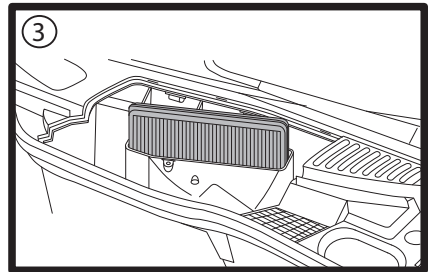

Remove used filter noting flow direction, replace with new Ryco RCA144P.

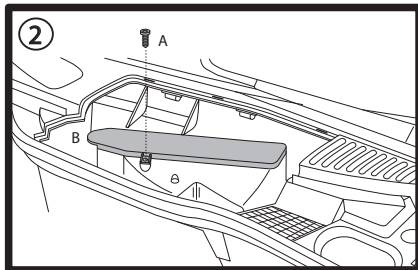

Remove the screw (A), hold the cover at the rounded end (B) pull upwards and remove filter cover.

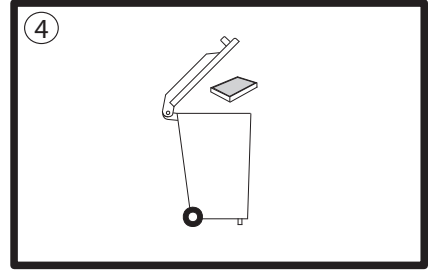

Refit all previously removed components in reverse sequence.
Dispose of used filter correctly.

Ryco Group Pty Ltd
29 Taras Ave, Altona North
Victoria 3025 Australia.
www.rycofilters.com.au

Ryco Group
A Division of GUD NZ Holdings Ltd
626A Rosebank Road, Avondale
Auckland New Zealand
www.ryco.co.nz