

RCA104M SUBARU OUTBACK

FILTER IS LOCATED BEHIND THE GLOVE BOX

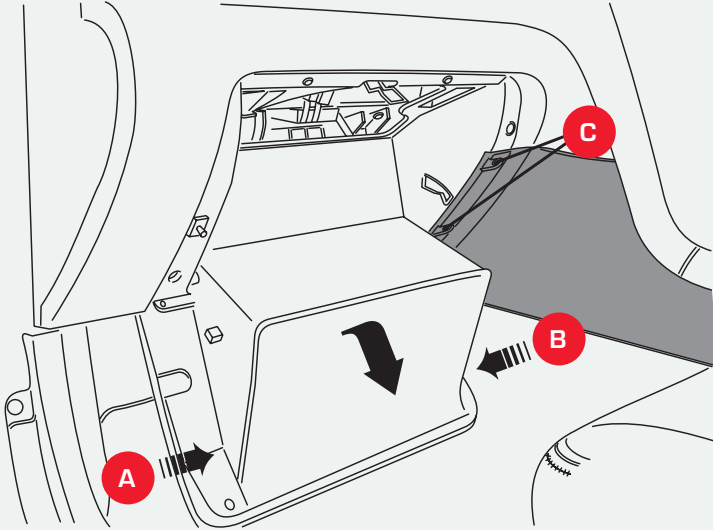

STEP 1

Open the glove box and push each side of the glove box (A & B) to release the catches. The glove box can then be rolled down to a 6 o'clock position. Unclip the trim panel (push/pull clips) (C) to reveal hidden screw.

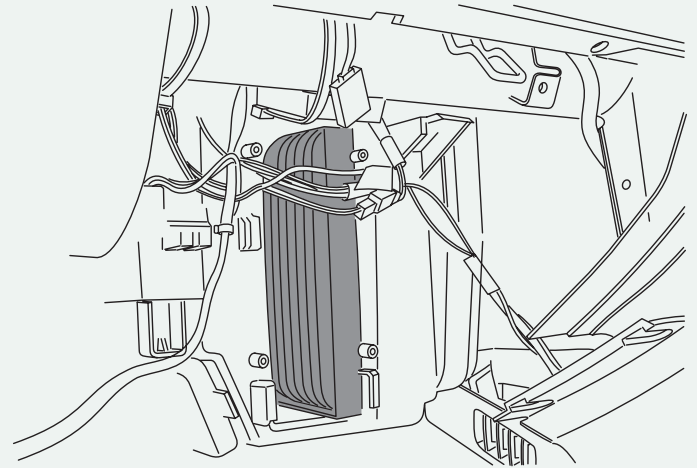

STEP 3

Remove 5 screws & 2 hex head bolts from around the glove box frame, and gently pull glove box out until the plug for the glove box light is visible and disconnect. Remove the glove box to expose cover for cabin filter. Remove cover to gain access to filter by pulling out.

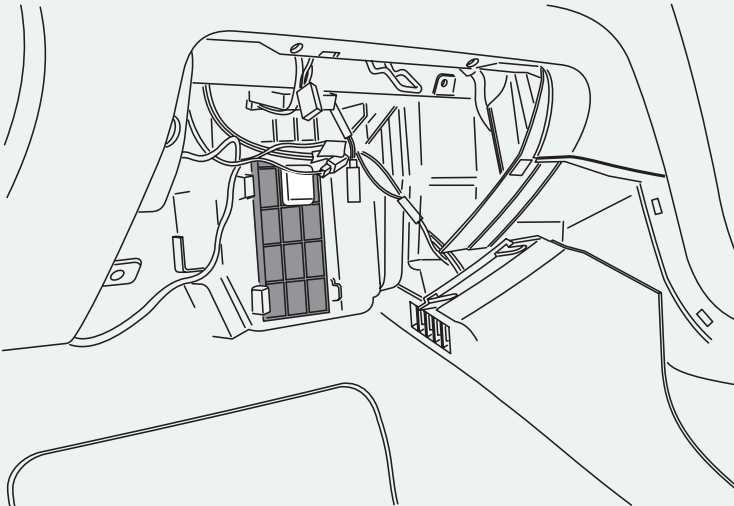

STEP 2

Hold wires away from front of housing. Pull used filter out from housing and replace with new Ryco RCA104M filter and re-assemble all previously removed components.

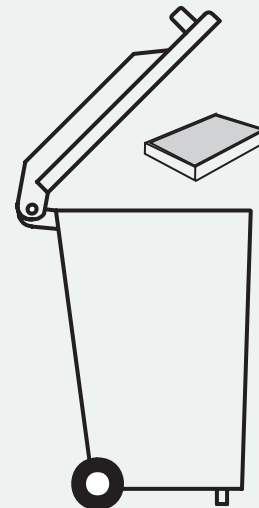

STEP 4

Dispose of used filter.

RCA104M AVENSIS VERSO

FILTER IS LOCATED BEHIND THE GLOVE BOX

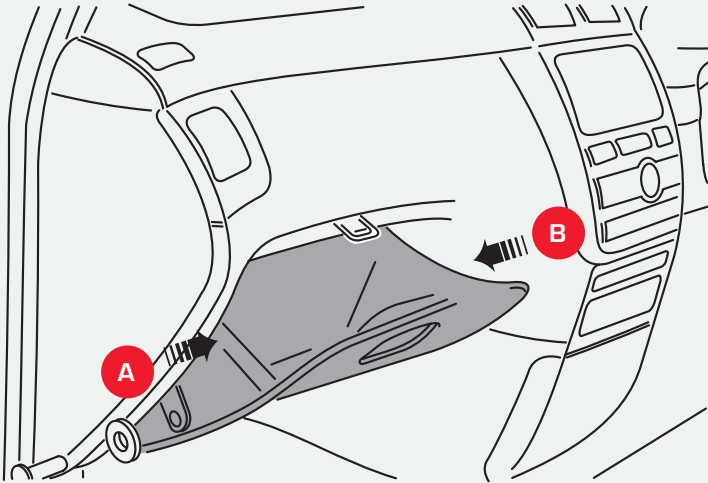

STEP 1

Push sides of glove box (A & B) to release catches, roll glove box down, unclip hinges to remove glove box.

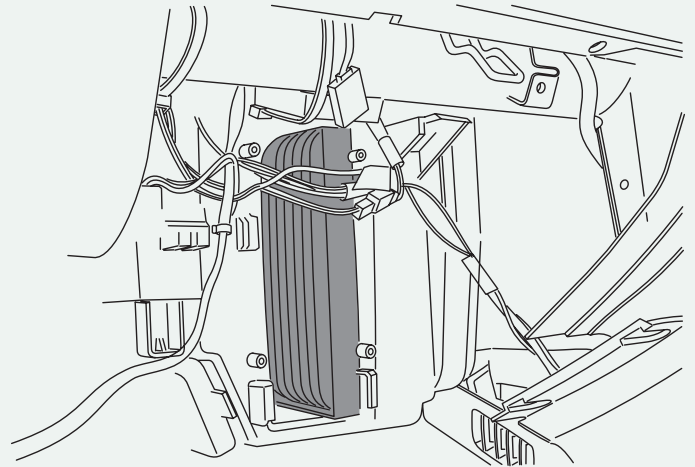

STEP 3

Remove used filter from tray. Fit new Ryco filter: Refit all previously removed components.

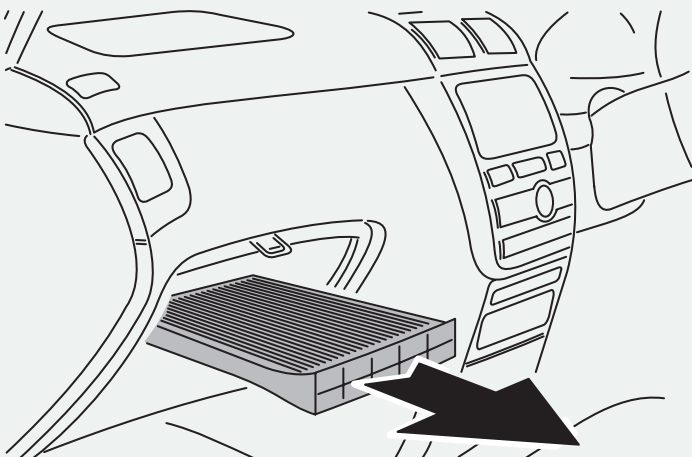

STEP 2

Slide filter tray out from glove box compartment.

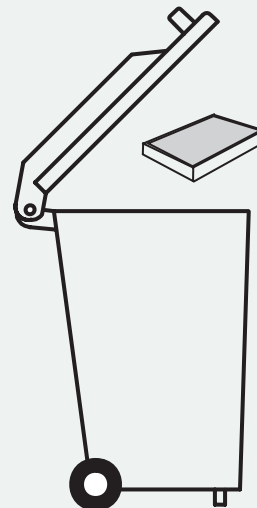

STEP 4

Clean filter housing, dispose of used filter correctly.

RCA104M TOYOTA LANDCRUISER PRADO

FILTER IS LOCATED BEHIND THE GLOVE BOX

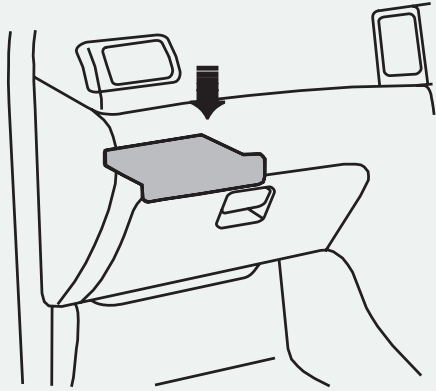

STEP 1
The cabin air filter is located behind the glove box.

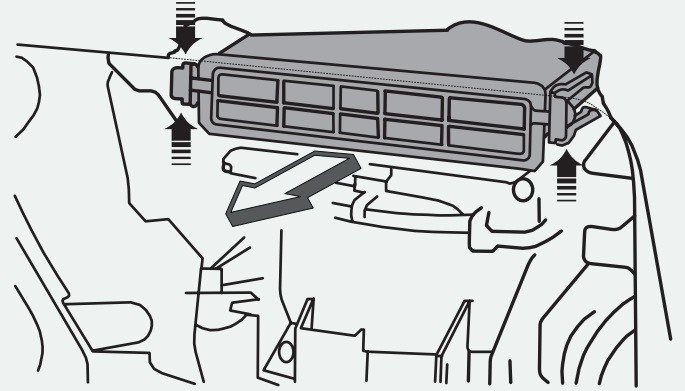

STEP 4
To remove filter assembly, hold tray on both sides as shown and pull out.

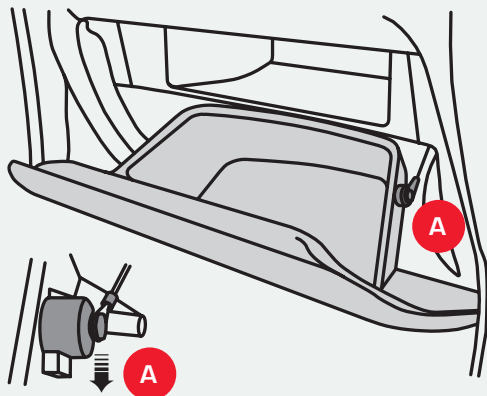

STEP 2
Open the glove box and remove the glove box support by sliding the clip (A) down.

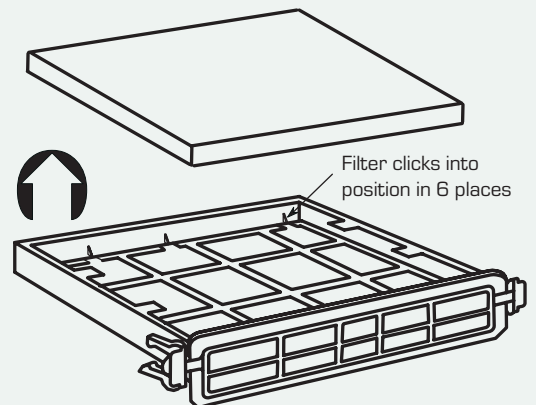

STEP 5
Remove used filter from tray, fit new filter to tray making sure that flat side is facing down.

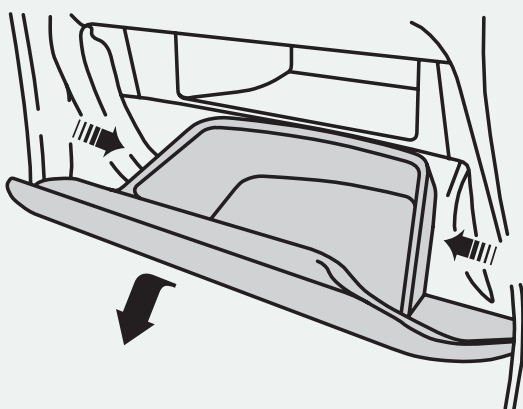

STEP 3
Push each side of glove box (A & B) to release catches, then remove the glove box.

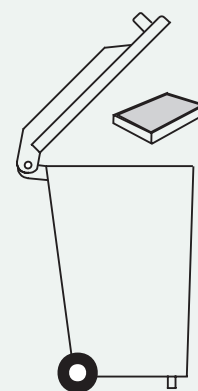

STEP 6
Push new filter assembly and tray into position then refit all previously removed components. Dispose of used filter correctly

RCA104M TOYOTA PRIUS

FILTER IS LOCATED BEHIND THE GLOVE BOX

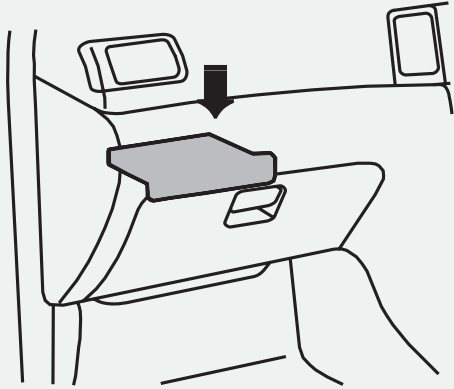

STEP 1
The cabin air filter is located behind the glove compartment.

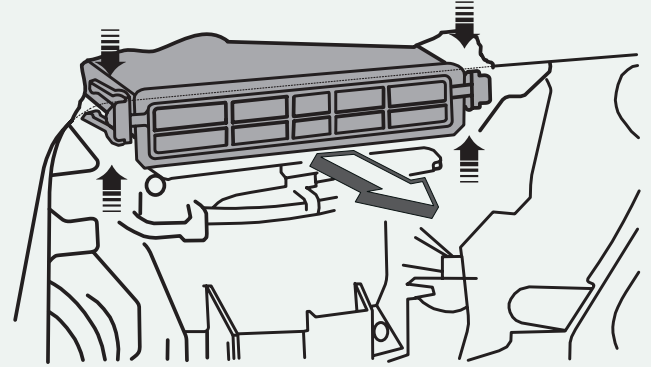

STEP 4
To remove filter assembly, hold tray on both sides as shown and pull out

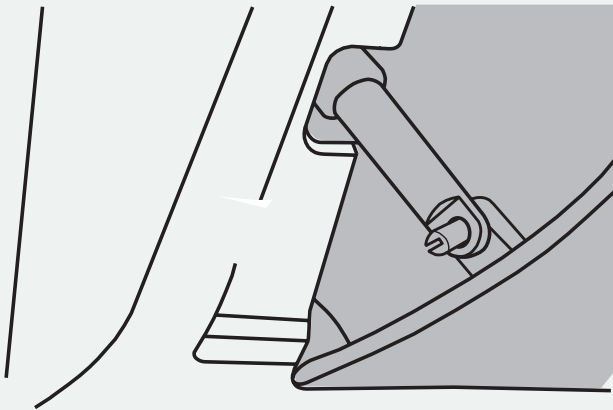

STEP 2
Open the glove compartment & remove the support arm by sliding arm of the pin.

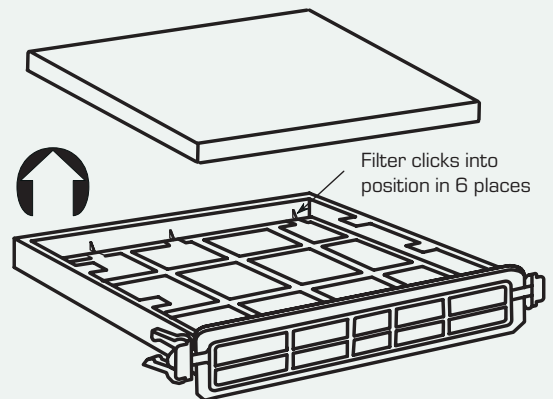

STEP 5
Remove used filter from tray, fit new filter to tray making sure that flat side is facing down.

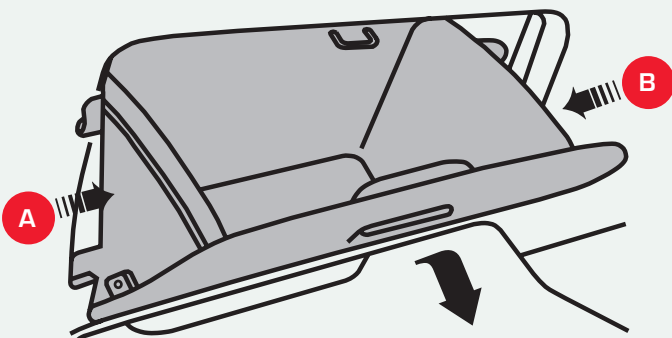

STEP 3
Push each side of glove compartment (A & B) to release catches then remove glove compartment.

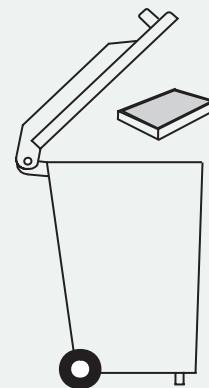

STEP 6
Push new filter assembly and tray into position then refit all previously removed components. Dispose of used filter correctly

RCA104M TOYOTA AVENSIS

FILTER IS LOCATED BEHIND THE GLOVE BOX

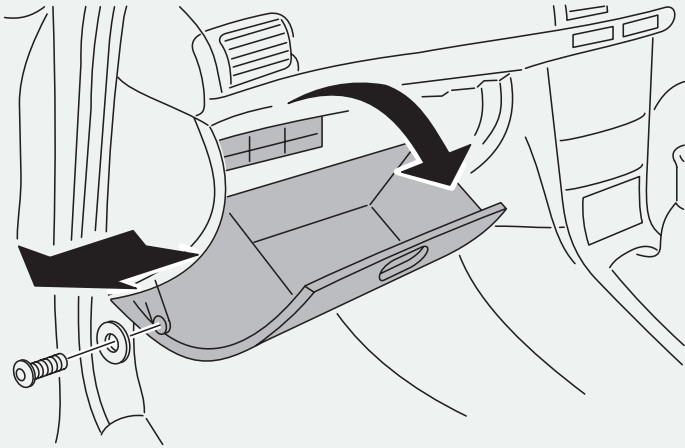

STEP 1
Open glove box, remove screw and washer, then remove the glovebox.

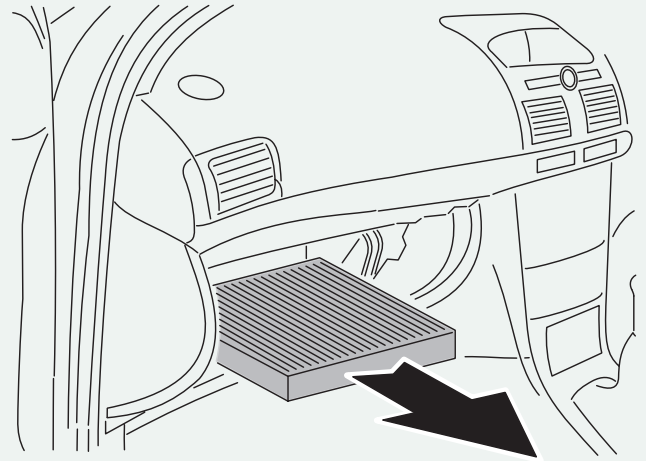

STEP 3
Remove used filter.

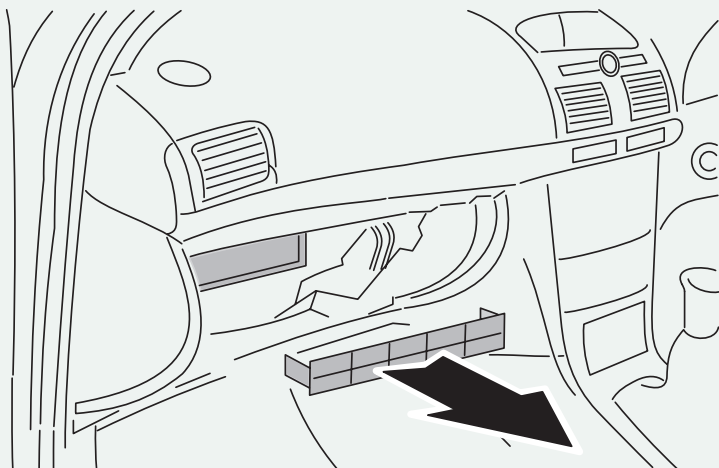

STEP 2
Remove filter cover.

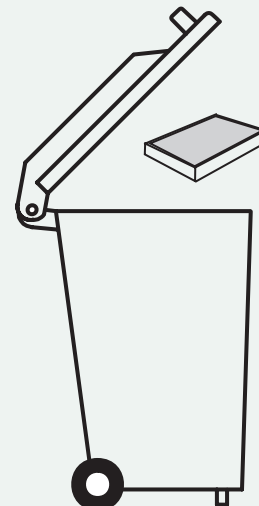

STEP 4
Fit new Ryco filter; refit all previously removed parts, dispose of used filter correctly.

RCA104M TOYOTA CELICA

FILTER IS LOCATED BEHIND THE GLOVE BOX

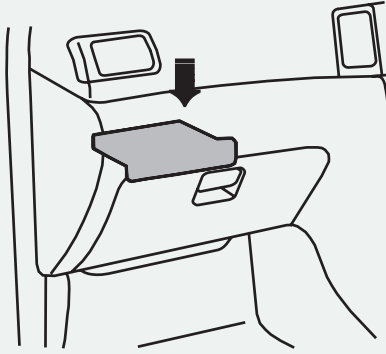

STEP 1
The cabin air filter is located behind the glove compartment.

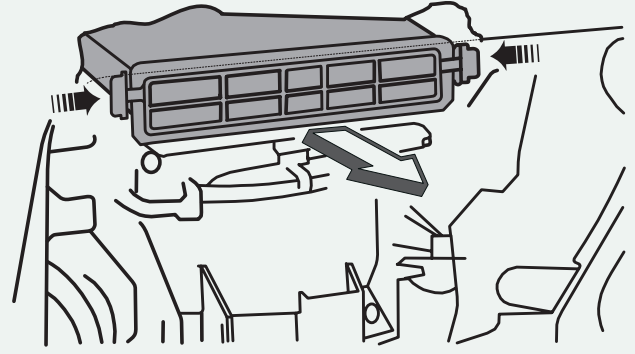

STEP 4
To remove filter assembly, squeeze tabs on both sides as shown and pull filter assembly out.

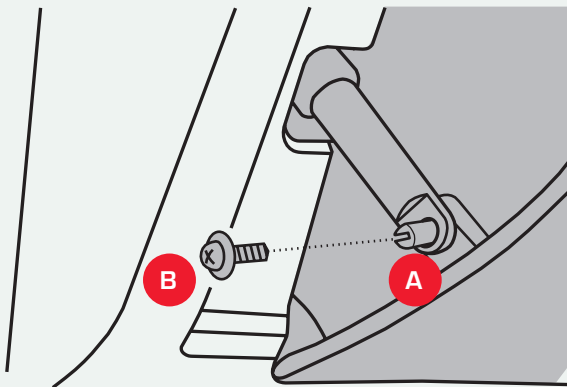

STEP 2
Open the glove compartment and remove the support arm by sliding the arm off the pin (A) or removing the screw (B) (if either are fitted).

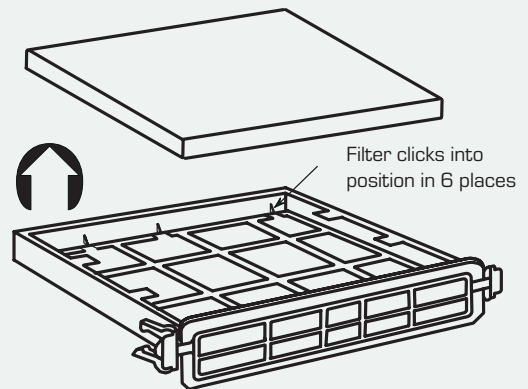

STEP 5
Remove used filter from tray, fit new filter to tray making sure that flat side is facing down.

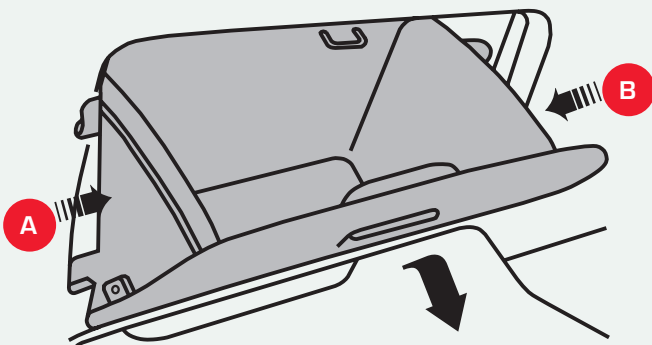

STEP 3
Push each side of glove box (A&B) to release catches then lift back of glove box to release hinges then remove glove box. (Glove box remains attached on left hand side)

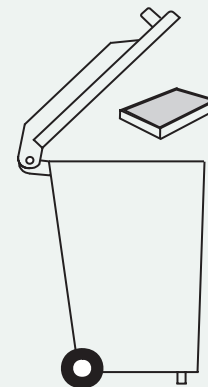

STEP 6
Push new filter assembly and tray into position then refit all previously removed components. Dispose of used filter correctly