

## FITTING INSTRUCTIONS FOR RYCO R2132P.

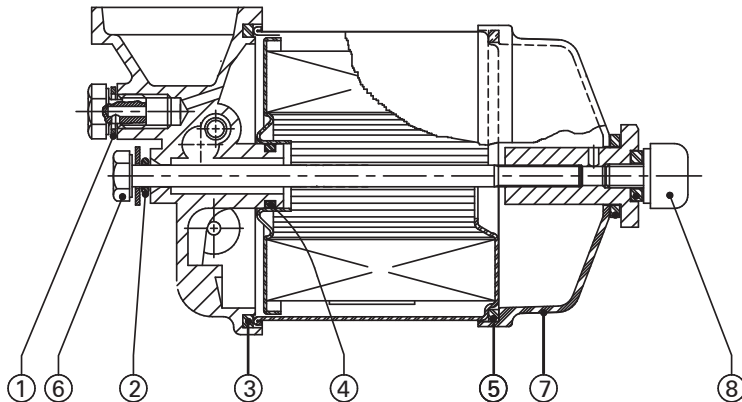

- 1: Undo drain screw ⑧ and drain unit.
- 2: Undo centre bolt ⑥ while holding bowl ⑦.
- 3: Remove filter by pulling and rotating.
- 4: Remove and discard used seal and gaskets. ② ③ ④ ⑤
- 5: Fit new gasket to filter head ③.  
Fit new "O" ring to spigot ④.  
Fit new filter by pushing over "O" ring ④.  
(use fuel to lubricate "O" ring)
- 6: Fit new gasket/seal to bowl ⑤ & centre bolt ②.  
Fit centre bolt and torque to 6 Ft lb (8 - 11 Nm)
- 7: Remove used seal ① from bleed screw, fit new seal and replace bleed screw.
- 8: Bleed fuel system, start engine and check for leaks.+

**NOTE:** Do not overtighten the centre bolt in an attempt to cure any leaks appearing at the sealing gaskets but dismantle the unit and examine the sealing faces and rings for damage, Overtightening the centre bolt beyond the recommended torque figure may permanently distort the base or filter element or break the bowl.

**NOTE :** Filter max working pressure : 206 kPa (30 psi)  
Nominal flow rate : 40-45 litres/hour