

X119FW™

X119FW FUEL WATER SEPARATOR FITMENT INSTRUCTIONS

FORD RANGER 06/2022 ../ON AND VOLKSWAGEN AMAROK 12/2022 ../ON - See RYCO catalogue for specific application details. The Ryco X119FW kit includes a mounting bracket specifically designed for the vehicle, and all components required to complete the installation of Ryco Z980SK16 series fuel water separator. It is recommended that the installation is conducted by a qualified mechanic following the procedures in this instruction sheet.

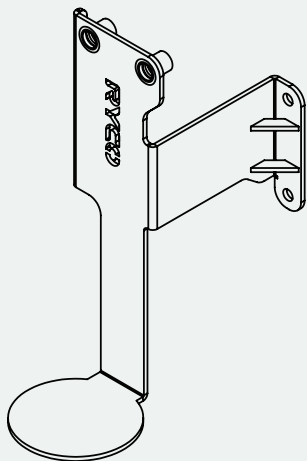
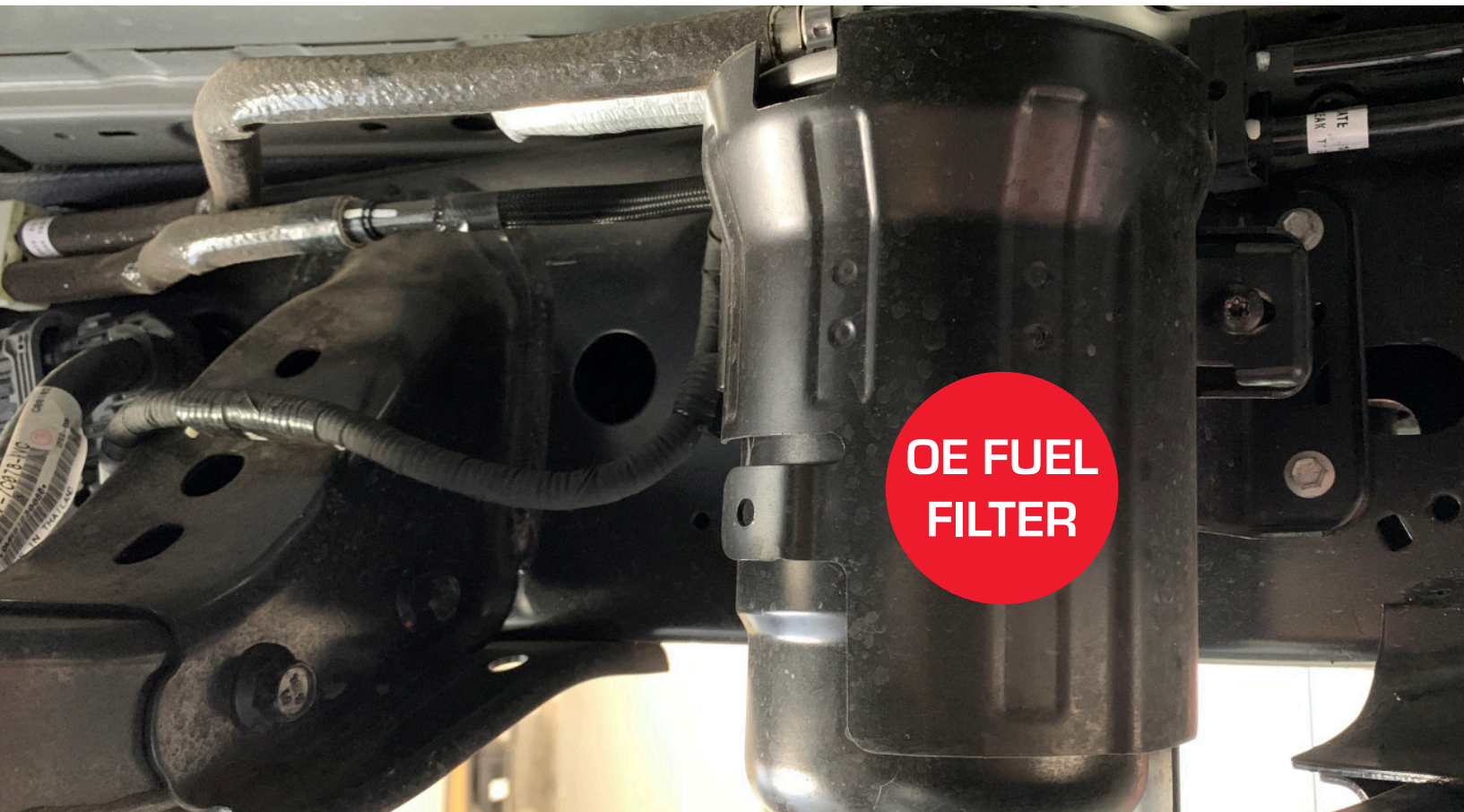

SECTION 1A
FUEL WATER SEPARATOR MOUNTING BRACKET



SECTION 1B
FUEL WATER SEPARATOR

COMPONENTS INCLUDED IN X119FW KIT

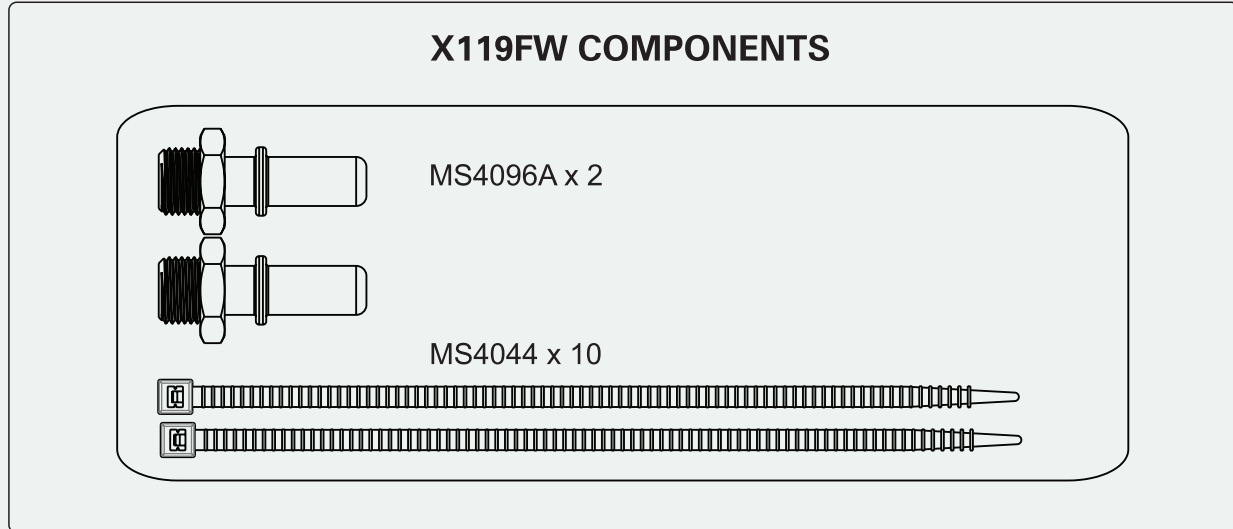

PARTS LIST - BRACKET, FUEL FILTER COMPONENTS

FB9819FC
MOUNTING BRACKET x 1

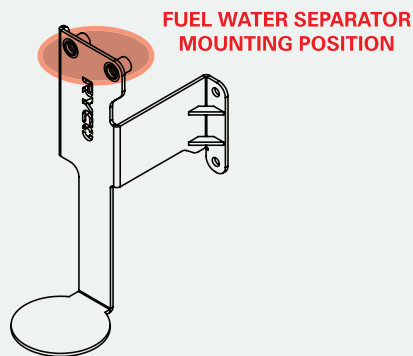

MF9819A ASSY
FUEL HOSE x 1

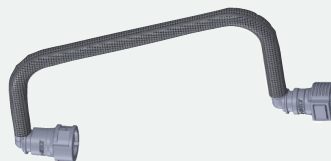

MF9819B ASSY
FUEL HOSE x 1



SECTION 1A FUEL WATER SEPARATOR INSTALLATION

PARTS REQUIRED

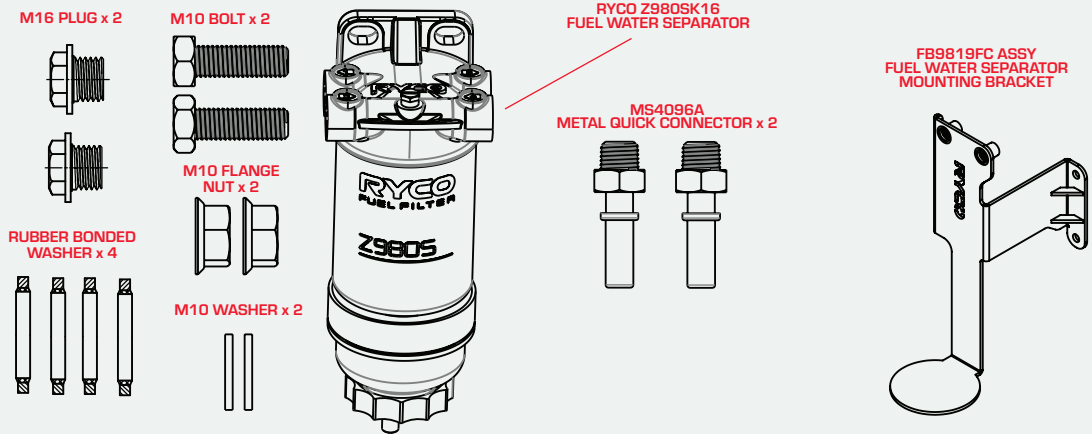

TOOLS & PPE REQUIRED

- Work Gloves
- Ratchet Set
- Hose Clamp Pliers
- Rags

WORK PROCEDURE

- 1 Select the supplied quick connects, blanking plugs and rubber bonded washers.
- 2 Install the Ryco fuel water separator head with metal quick connectors, blanking plugs and rubber bonded washers, as per FIG. 1. Tighten blanking plugs (on port 3 & 4) and quick connectors (on port 1 & 2). (Note ensure these are only tightened by hand to avoid damaging the rubber bonded washers.)
- 3 Mount Z980SK16 assembly onto the fuel water separator bracket using the two (2) black M10 bolts & washers supplied with the Z980SK16 and tighten these fasteners, as per FIG. 2.

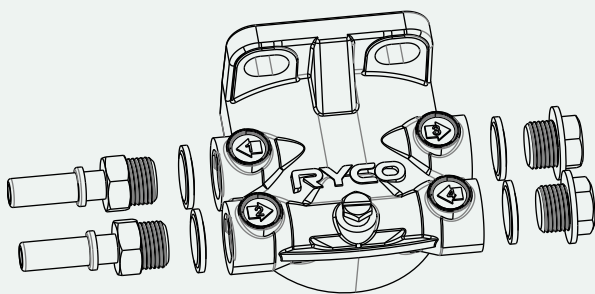

FIGURE 1
FUEL WATER SEPARATOR COMPONENTS PREPARATION

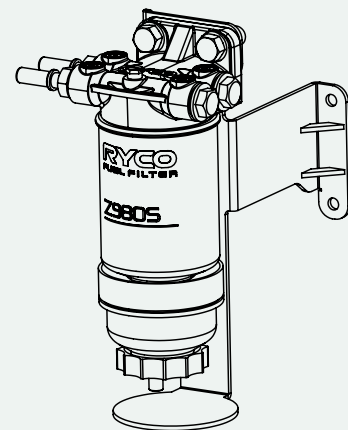
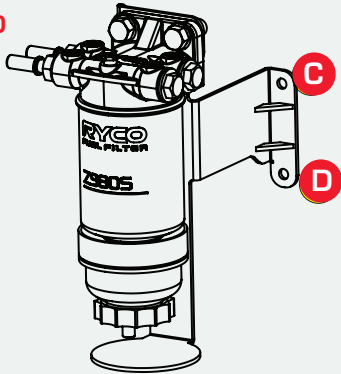

FIGURE 2
FUEL WATER SEPARATOR MOUNTING ASSEMBLY

SECTION 1B FUEL WATER SEPARATOR MOUNTING BRACKET FITMENT

PARTS REQUIRED



MF9819A ASSY
FUEL HOSE x 1

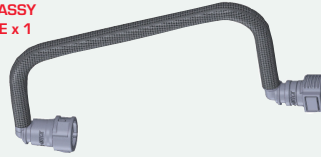

MF9819B ASSY
FUEL HOSE x 1



TOOLS & PPE REQUIRED

- Work Gloves
- Ratchet Set

WORK PROCEDURE

- 1 Loosen harness fixed points A & B in the OE filter left side as per FIG. 3.
- 2 Remove left hand two OE filter factory M6 x 25 bolts from point C & D as per FIG. 4A.
- 3 Loosen the three clamps marked 1, 2 and 3. Loosen the factory fuel hose quick connectors E & F and take out the fuel supply line from the tank to the factory filter. Have a rag ready to capture any diesel that may spill out of the fuel line and the fuel filter inlet pipe as per FIG. 4A & 4B.

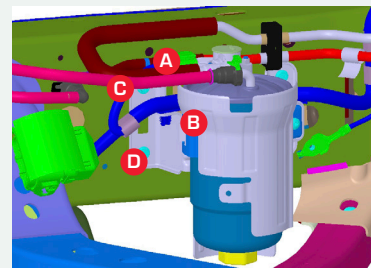

FIGURE 3
OE BRACKET IN CHASSIS

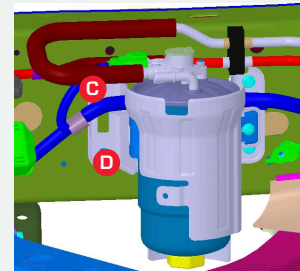

FIGURE 4A
OE BRACKET PARTIAL REMOVED

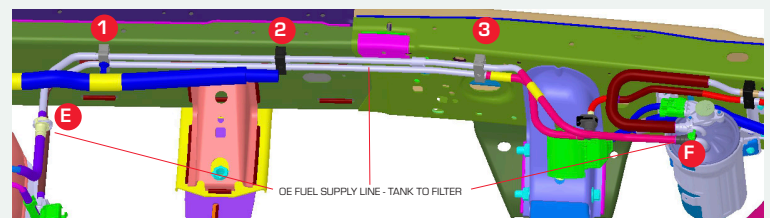

FIGURE 4B
OE FUEL HOSES CLAMPS NEED BE LOOSEN

SECTION 1B FUEL WATER SEPARATOR INSTALLATION (CONTINUED)

WORK PROCEDURE (CONTINUED)

- 4 Position the bracket on the left hand place of the OE filter bracket as per FIG. 5, placing point C at the top OE filter bracket holes, placing point D at the bottom place of the OE filter bracket.
- 5 Refit the factory M6 bolts at point C & D point onto the factory filter bracket as per FIG. 5.
- 6 Fastener the OE filter M6 bolts at point C & D as per FIG. 6.
- 7 Connect the supplied MF9819A fuel hose to the outlet port fitting of the Z980SK16 (port 1 - inside) and connect the other end to the factory fuel filter inlet port and secure with the locker on. See FIG.7 for fuel hose routing.
- 8 Connect the supplied MF9819B fuel hose (135 degree quick connect side end) to the inlet port fitting of the Z980SK16 and connect the other end (90 degree male side end) to the factory tank outlet port and secure with the locker on. See FIG. 8A , 8B & 8C for fuel hose routing.

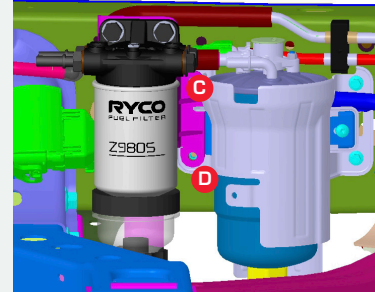

FIGURE 5
FUEL WATER SEPARATOR INSTALLATION

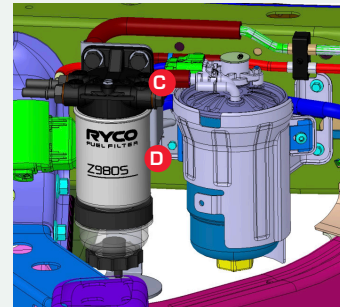

FIGURE 6
FUEL WATER SEPARATOR & OE FUEL FILTER INSTALLATION

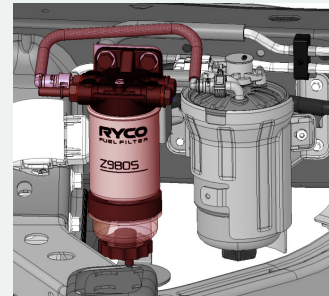

FIGURE 7
FUEL HOSE INSTALLATION - FUEL WATER SEPARATOR TO OE FILTER



FIGURE 8A
FUEL HOSE INSTALLATION - TANK END SIDE

SECTION 1B FUEL WATER SEPARATOR INSTALLATION (CONTINUED)

WORK PROCEDURE (CONTINUED)

- 9 The fuel supply lines are preformed and should not require to be bent in any way. Carefully slide through mounting points and then ensure you have secured the locking tabs.. Ensure the locking tab is engaged. Check the fuel pipes routing to ensure they're not kinked. (See FIG. 9)
- 10 Ensure all quick connectors and locking tabs are secure. Check both fuel hoses are not jammed or kinked. For added security, use the supplied cable ties to secure the fuel hoses if necessary.

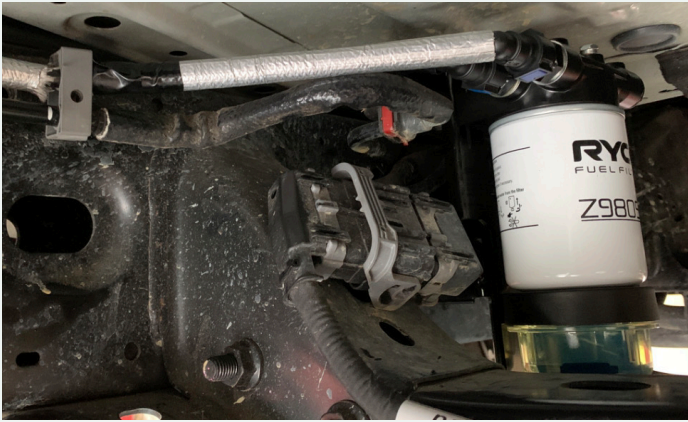

FIGURE 8B
FUEL HOSE INSTALLATION - FUEL WATER SEPARATOR END SIDE



FIGURE 8C
FUEL HOSE INSTALLATION - FUEL WATER SEPARATOR END SIDE

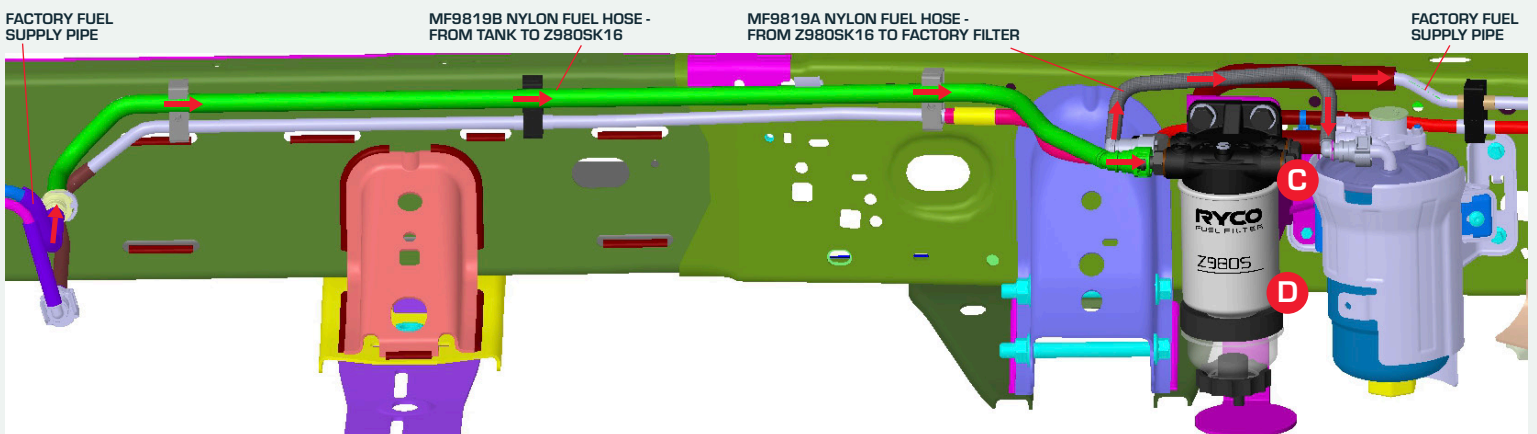

FIGURE 9
FUEL WATER SEPARATOR INSTALLATION

