

## X104FW™

### X104FW FUEL WATER SEPARATOR FITMENT INSTRUCTIONS

**TOYOTA LAND CRUISER PRADO KDJ & GDJ - See RYCO catalogue for specific application details.**

The Ryco X104FW kit includes mounting brackets specifically designed for the vehicle, and all components required to complete the installation of Ryco Z980K16 series fuel water separator. It is recommended that the installation is conducted by a qualified mechanic following the procedures in this instruction sheet.



FUEL FILTER  
BRACKET  
LOCATION

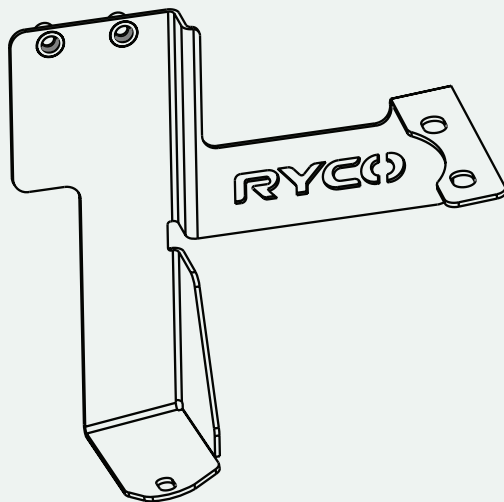

SECTION 1  
FUEL WATER SEPARATOR MOUNTING BRACKET

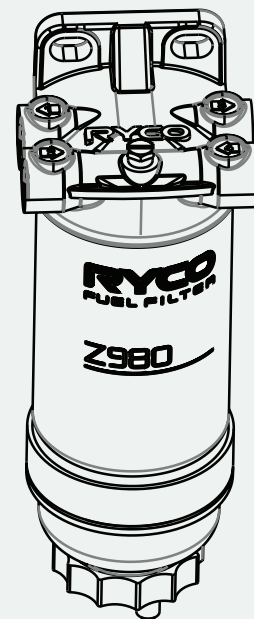

SECTION 2  
FUEL WATER SEPARATOR

### COMPONENTS INCLUDED IN X104FW KIT

#### PARTS LIST - FUEL FILTER BRACKET & COMPONENTS BOX

MS4044  
CABLE TIE x 20



MS4096A  
QUICK CONNECTOR x 2

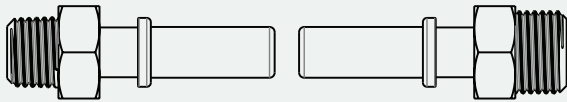

MS4042  
FUEL HOSE CLAMP x 2

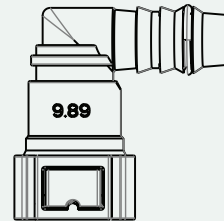
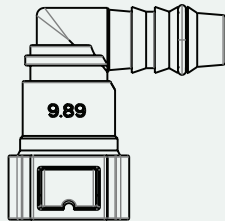
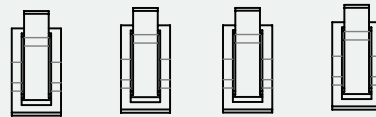

MS4081  
ELBOW CONNECTOR x 2



MS4036  
FLAT WASHER x 2 (M6)



MS4099  
NYLON LOCK NUT x 1 (M6)



MS4037  
HEX BOLT x 1 (M6)

### COMPONENTS INCLUDED IN X104FW KIT

**FB9804FC**  
FUEL FILTER MOUNTING BRACKET x 1

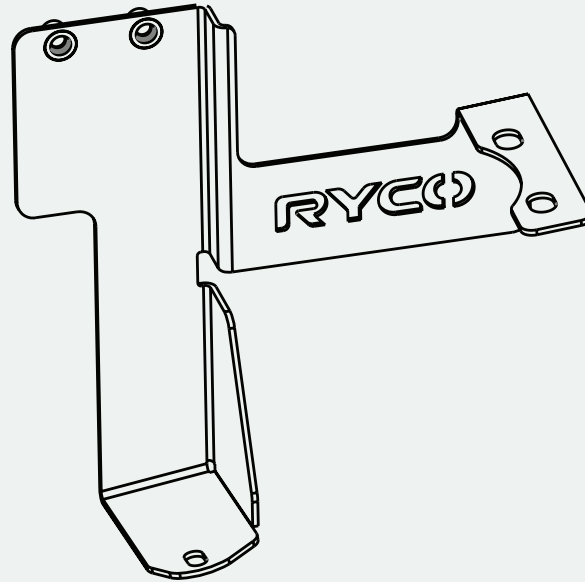

**HF9804A**  
FUEL HOSE x 1 (210mm)



**HF9804B**  
FUEL HOSE x 1 (360mm)

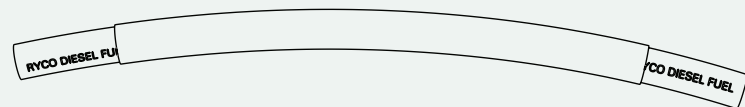

### SECTION 1 FUEL WATER SEPARATOR BRACKET FITMENT

#### PARTS REQUIRED

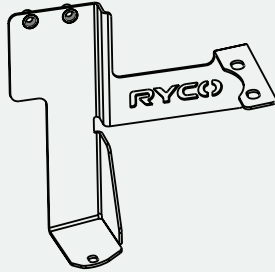

**FB9804FC**  
Fuel Filter Metal Bracket



**MS4036**  
Washer x 2 (M6)

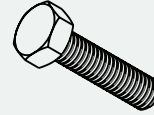

**MS4037**  
Hex Bolt x 1 (M6)



**MS4099**  
Nylon Lock Nut x 1 (M6)

#### TOOLS & PPE REQUIRED

- Ratchet Set
- Work Gloves

#### WORK PROCEDURE

- 1 Remove the two nuts (marked A in FIG. 1) securing the factory filter to the vehicle. Lift the factory filter and fit Ryco fuel filter metal bracket in the same position as the factory fuel filter. Place the factory filter housing on top of the Ryco fuel filter bracket and slightly tighten the nuts previously removed.
- 2 Use the supplied 6mm bolt, nut and washers to secure the bottom section of the Ryco bracket through the hole in the vehicles front passenger side wheel house. Note: Install the factory bolt at point B in FIG. 1 in the orientation shown. The bolt should be installed from the wheel house up in to the engine bay so the bolt does not protrude down under the vehicle.
- 3 Tighten all fasteners.

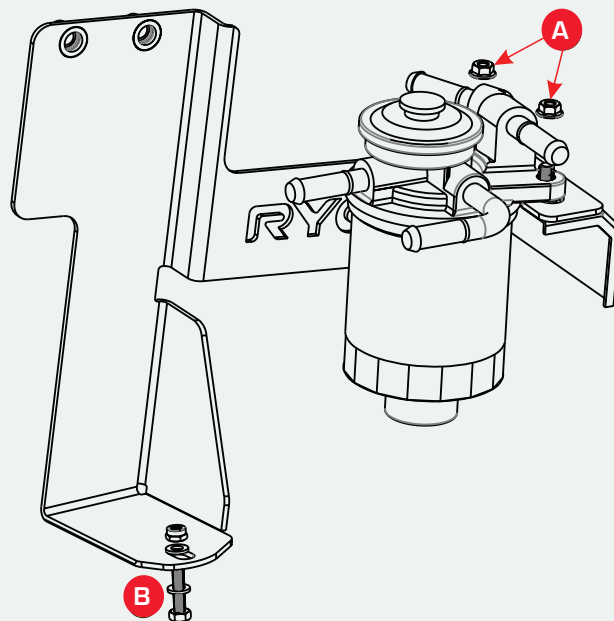

**FIGURE 1**  
BRACKET INSTALLATION

### SECTION 2 FUEL WATER SEPARATOR INSTALLATION

#### PARTS REQUIRED

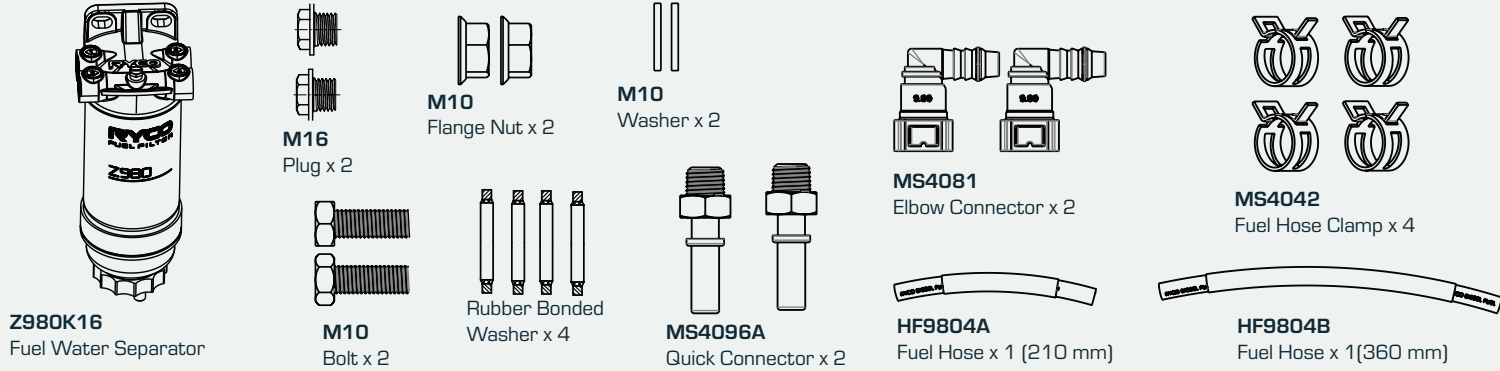

#### TOOLS & PPE REQUIRED

- Ratchet Set
- Work Gloves
- Hose Clamp Pliers
- Rags

#### WORK PROCEDURE

- 1 Select the supplied quick connectors that fit the Ryco fuel water separator head.
- 2 Locate the blanking plugs supplied with the fuel water separator.
- 3 Install the Ryco fuel water separator head with metal quick connectors, blanking plugs and rubber bonded washers, as per FIG 2. Tighten blanking plugs (on Port 3 & 4) and quick connectors (on Port 1 & 2).
- 4 Install one of the supplied elbow connector onto one end of supplied fuel hoses and install two (2) supplied fuel hose clamps onto both ends of fuel hoses, as per FIG. 3. Do not tighten fuel hose clamps yet.

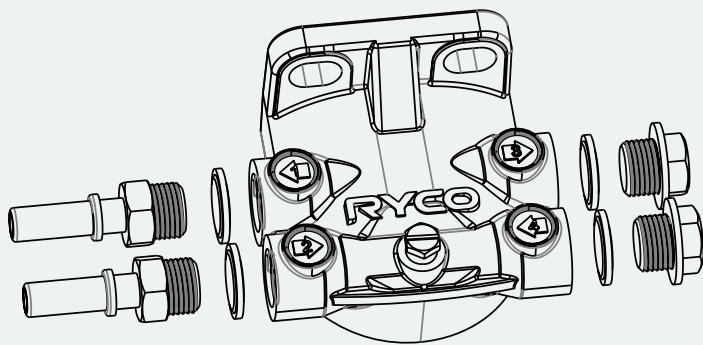

FIGURE 2  
FUEL WATER SEPARATOR HEAD PREPARATION

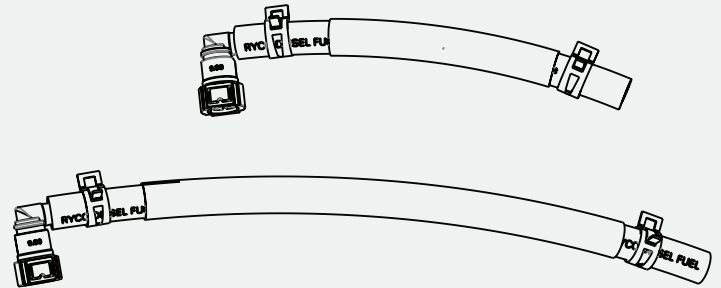

FIGURE 3  
FUEL HOSE PREPARATION

### SECTION 2 FUEL WATER SEPARATOR INSTALLATION

#### WORK PROCEDURE

- 5 Locate the factory fuel inlet hose (coloured blue in FIG. 4) at the factory fuel filter. Loosen the factory fuel hose clamp and disconnect the fuel supply line from the factory filter. Have a rag ready to capture any diesel that may spill out of the fuel line and the fuel filter.
- 6 Trace the other end of the fuel supply line and disconnect it from the metal factory fuel supply pipe, as per FIG. 4. Remove the factory fuel supply line from the vehicle and store for safe keeping. Have a rag ready to capture any diesel that may spill out of the fuel lines.
- 7 Mount the Z980K16 fuel filter assembly onto the metal bracket as per FIG. 6 using the two (2) black M10 bolts and washers supplied with the Z980K16.
- 8 Connect the open end of the shorter supplied fuel hose (HF9804A coloured red in FIG. 5) to the factory fuel supply pipe and secure with a hose clamp. Connect the elbow connector to the inlet port of the Z980K16 by pushing the elbow connector onto the metal quick connector until you hear a “click”. See FIG. 5 for hose routing.
- 9 Connect the longer hose (HF9804B coloured yellow in FIG. 5) to the outlet port of the Z980K16 by pushing the elbow connector on to the metal quick connector until you hear a “click”, and connect the open end of the fuel hose to the factory fuel filter inlet port and secure with a hose clamp.
- 10 Locate the priming button on top of the factory fuel filter. Prime the fuel system by pumping the button repeatedly until you feel it go hard and become difficult to press any further. The priming process could take approximately 5 - 10 minutes.
- 11 Start the engine and check for fuel leaks.

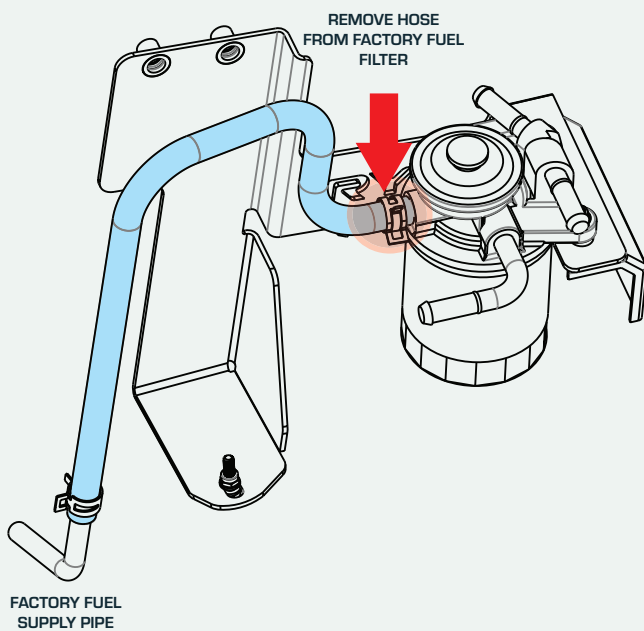

FIGURE 4  
FACTORY HOSE IDENTIFICATION

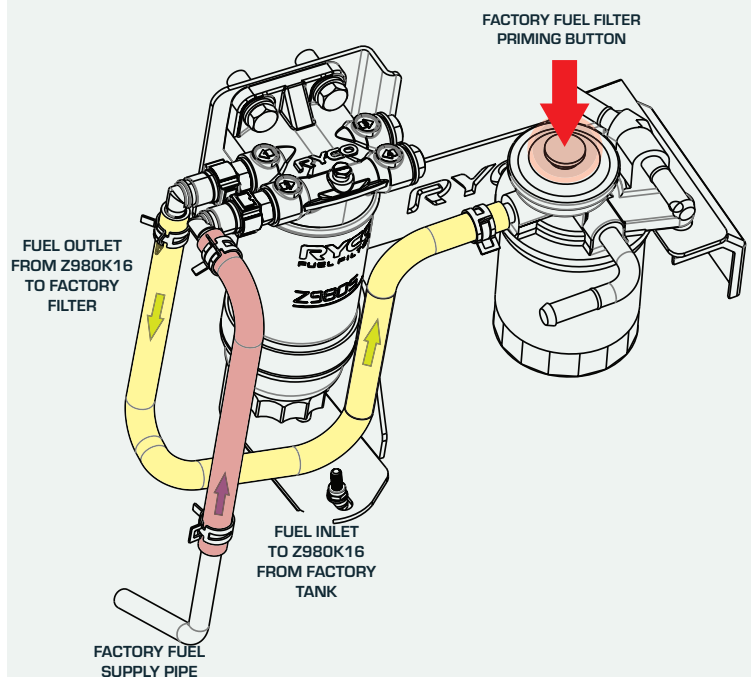

FIGURE 5  
FUEL WATER SEPARATOR INSTALLATION

## X104FW™

### X104FW FUEL WATER SEPARATOR FITMENT INSTRUCTIONS